

Turbo Disperser

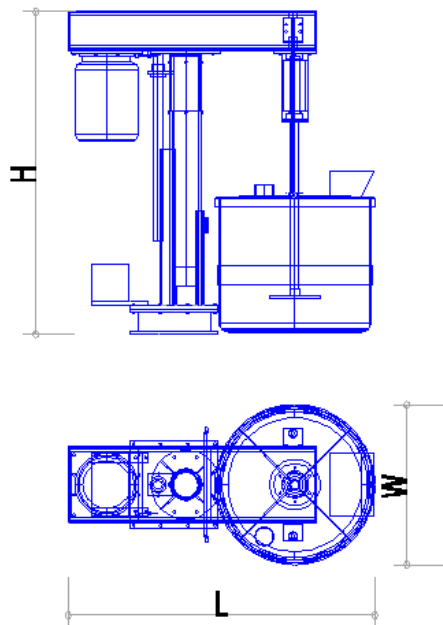

SPECIFICATIONS & MODELS



Turbo Disperser with optional rotating lateral scrapper, for dissolving solid particles in a liquid.

- The machine framework can be secured to the floor or on a base.
- The mobile part is lifted by a single shaft hydraulic cylinder.
- The mobile part houses the drive and supports the mixing shaft, the cover and scrapper, if any.
- Belt drive is driven by inverter.
- PLC for machine control and supervision.
- All models have standard cover with inlet for powders or liquids feeding.

Model 304/1

- Flat cover in AISI 304 stainless steel.
- Mixing Bowl from AISI 304 stainless steel, with detachable safety belt.
- Anchor mixing shaft in AISI 304 Stainless steel.

Model 304/2

- Flat cover in AISI 304 stainless steel.
- Mixing Bowl from AISI 304 stainless steel, with detachable safety belt.
- Anchor mixing shaft in AISI 304 Stainless steel.
- Rotating Lateral scrapper in AISI 304 stainless steel with interchangeable scrapping blade, hydraulic driven.

Vessel Capacity (L)	Motor Power (kw)	W (mm)	L (mm)	Hmin (mm)	Hmax (mm)	Weight (kg)
1000	40	1000	2415	2568	3668	2000
650	25	800	2405	2568	3668	1800
450	18	800	2395	2568	3668	1500